

# Fa'atonuga mo le fa'aaogaina o le Doxy.me

Sauni mo lau talavai / siaki a le foma'i (appointment) e fa'aaogaina ai polokalame mo talanoaga e feso'ita'i ata (video) i luga o komepiuta, po o se talanoaga i le telefoni e feso'ota'i ai ma le au foma'i (telehealth)

- O le a ē mana'omia se telefoni e mafai ona feso'ota'i i le upega tafa'ilagi (smart phone), po o se komeputa po o se tablet e i ai le mea pu'e ata (camera) ma le mea pu'e leo (microphone)
- Ia mautinoa e lelei le feso'ota'iga i le upega tafa'ilagi (internet connection)
- Fa'aaoga se nofoaga/potu to'a filemu e lē pisapisaō, e lava le malamalama ia iloa gofie ai ata o ou fofoga, ma e lē fa'aaogaina fa'alaua'itele
- Ia mautinoa lou fa'afeso'ota'i (log in) i nai minute a o le'i o'o i le taimi ua fa'atulagaina o lau talavai / talanoaga ma le foma'i

Na tatau ona lafoina atu i lau imeli / tu'uina atu e lau foma'i le ala o feso'ota'iga i upega tafa'ilagi (link) e patino ia te oe. O'omi (kiliki) le link.

1

Afai e te le'i maua le link i lau imeli, o'omi / kiliki e tatala le itulau e mafai ai ona fa'aaoga le upega tafa'ilagi (web browser) i luga o lau komeputa/tablet po o le telefoni (o fa'ata'ita'iga o web browser: Google Chrome, Safari po o le Firefox). Fa'afeso'ota'i e ala i le tāina (type) o le link i le avanoa mo tuatusi o itulau o le upega tafa'ilagi (web address bar) e patino i lau foma'i ona kiliki lea o le ulufale (enter).

*\*telefoni e fesili mo le link e patino i lau foma'i pe afai e te le'i mauaina.*

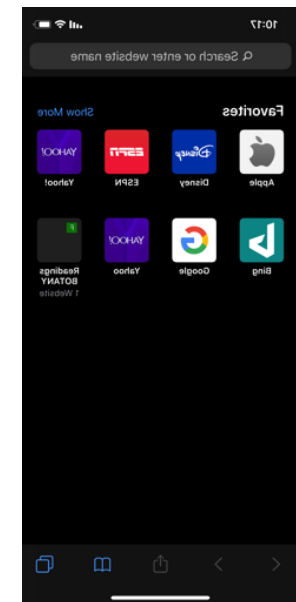
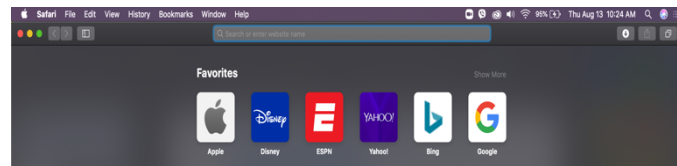
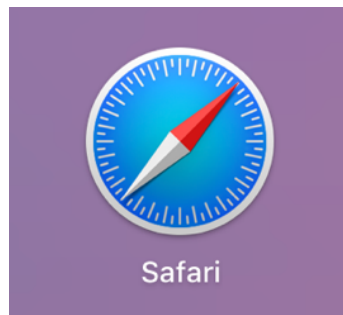

# 2

Fa'atumu lou suafa ma lou fa'ai'u i le avanoa, kiliki le "Check In" e silafia ai e le foma'i ua ē feso'ota'i atu.

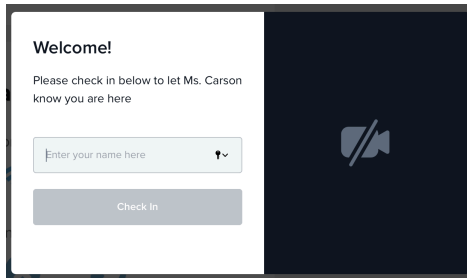

# 3

O'omi/Kiliki le "Give access to camera and mic" ia mafai ai ona fa'aaogaina le mea pu'e ata ma le mea pu'e leo ma a lua talanoaga. O lea ua e i ai i le potu fa'atalitali "waiting room" mo lau foma'i. O le ā amataina e lau foma'i le lua talanoaga.

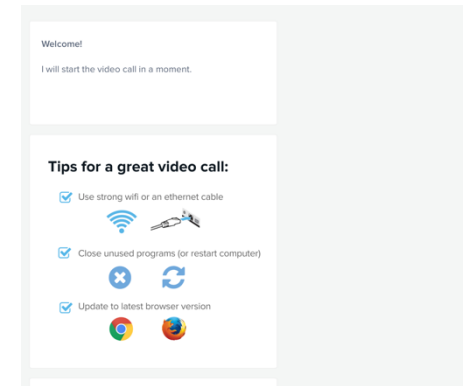
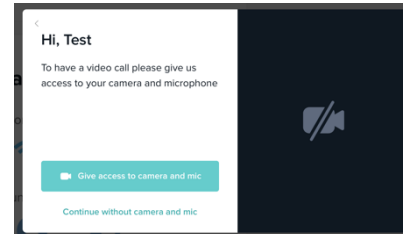

O lenei ala manuia ua tu'uina mai i le foa'i G22RH20213 mai le Ofisa mo le Alualu i Luma o Talavai e Fa'aaogaina ai Telefoni po o le Upega Tafa'ilagi (Telehealth), Ofisa o Alagā Manuia ma Au'aunaga mo le Soifua Maloloina, DHHS